

Detector Switches

Vertical Type Detector Switches

DF1 Series

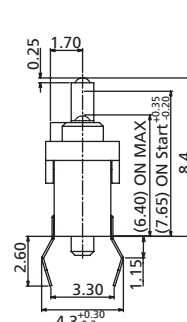
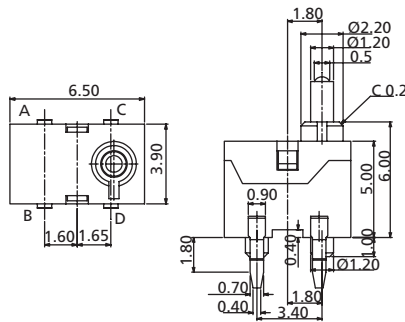
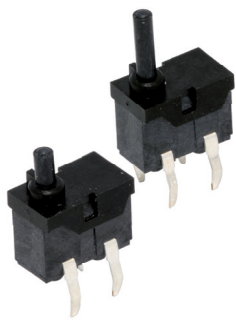

DF1HNA
Standard Actuator

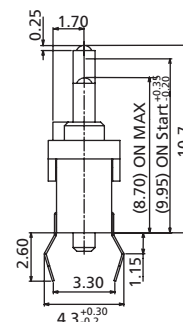

DF1HHA
High Actuator

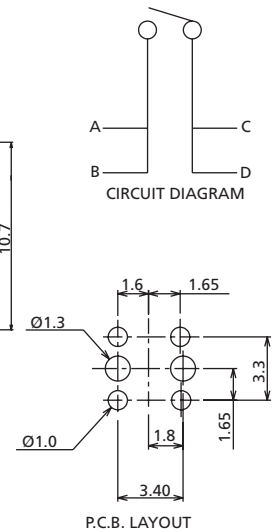

DF1H Thru Hole Type Terminals

Detector Switches

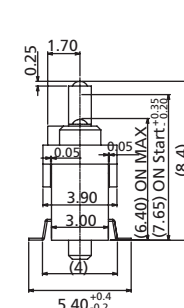
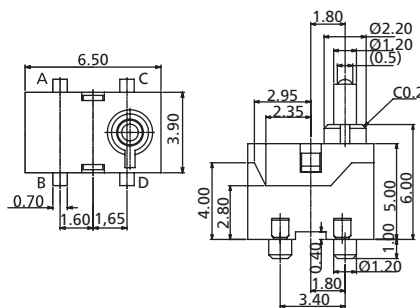

DF1SNA
Standard Actuator

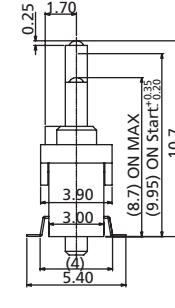

DF1SHA
High Actuator

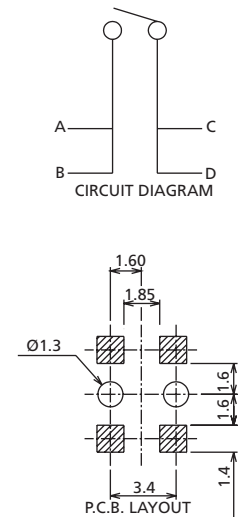

DF1S Surface Mounting Type Terminals

How to order:

DF1 1 2 3

1 TYPE OF TERMINALS:

- H Thru Hole Type
- S Surface Mounting Type

2 ACTUATOR TYPE:

- NA Standard Actuator
- HA High Actuator

3 PACKAGE STYLE:

- TB Tube
- TR Tape & Reel (DF1S Only)

General Specifications:

FEATURES

- » Compact detector switch with smooth switching action

MATERIALS

- » Contact: Stainless steel with silver cladding
- » Terminal: Phosphor bronze with silver plated

MECHANICAL

- » Operation Force: 30 gf max.
- » Stroke: 2 mm
- » Operation Temperature: -20°C to +70°C
- » Storage Temperature: -30°C to +80°C

ELECTRICAL

- » Electrical Life: 50,000 cycles
- » Rating: 5mA, 5VDC
- » Contact Arrangement: 1 pole 1 throw

LEADFREE SOLDERING PROCESSES

- » Wave Soldering: Recommended solder temperature at 260°C max.
- » Reflow Soldering: When applying reflow soldering, the peak temperature or the reflow oven should be set to 260°C 10 seconds max.

General Tolerance: ± 0.2 mm